

Ordering code

F0503 WR-S-XP XXX
 ① ② ③ ④ ⑤

① Series No.
 ② Connector type: WR=Right angle
 ③ Mounting type: S=SMT without boss
 ④ No. of circuits
 ⑤ Option code:
 T=Top contact style

SPECIFICATIONS

Current Rating: 0.5A AC,DC
 Voltage Rating: 50V AC,DC
 Temperature Range: -25°C ~ +85°C
 Contact Resistance: 30mΩ Max.
 Insulation Resistance: 100MΩ Min.
 Withstanding Voltage: 250V AC/minute
 Contacts: Phosphor Bronze/Gold-flash
 Solder Tabs: Brass/Gold-flash
 Housing: Nylon 6T,UL94V-0,Natural(Beige)
 Actuator: Nylon 6T,UL94V-0,Natural(Black)

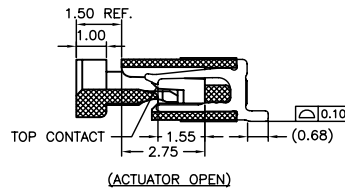
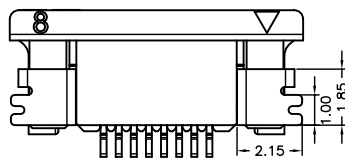
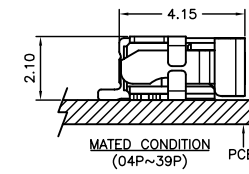
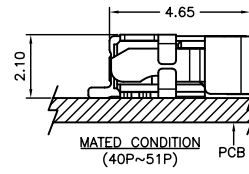
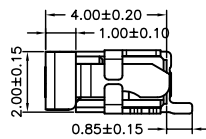
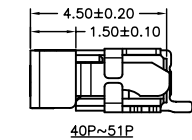
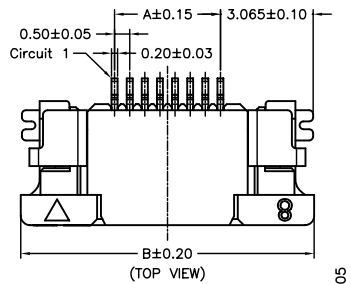
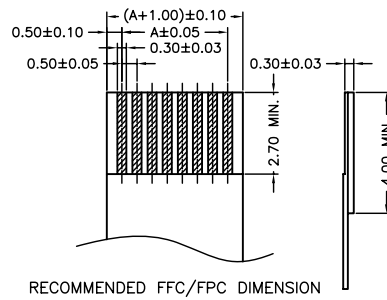
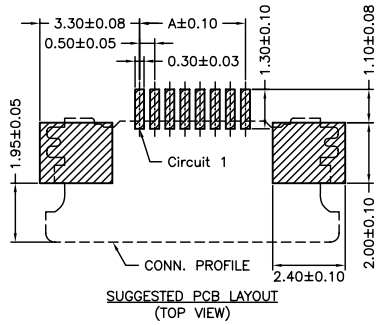

Circuit No.	Dimensions			Circuit No.	Dimensions		
	A	B	C		A	B	C
04P	1.50	7.70	2.60	25P	12.00	18.20	13.10
05P	2.00	8.20	3.10	26P	12.50	18.70	13.60
06P	2.50	8.70	3.60	27P	13.00	19.20	14.10
07P	3.00	9.20	4.10	28P	13.50	19.70	14.60
08P	3.50	9.70	4.60	29P	14.00	20.20	15.10
09P	4.00	10.20	5.10	30P	14.50	20.70	15.60
10P	4.50	10.70	5.60	31P	15.00	21.20	16.10
11P	5.00	11.20	6.10	32P	15.50	21.70	16.60
12P	5.50	11.70	6.60	33P	16.00	22.20	17.10
13P	6.00	12.20	7.10	34P	16.50	22.70	17.60
14P	6.50	12.70	7.60	35P	17.00	23.20	18.10
15P	7.00	13.20	8.10	36P	17.50	23.70	18.60
16P	7.50	13.70	8.60	37P	18.00	24.20	19.10
17P	8.00	14.20	9.10	38P	18.50	24.70	19.60
18P	8.50	14.70	9.60	39P	19.00	25.20	20.10
19P	9.00	15.20	10.10	40P	19.50	25.70	20.60
20P	9.50	15.70	10.60	45P	22.00	28.20	23.10
21P	10.00	16.20	11.10	49P	24.00	30.20	25.10
22P	10.50	16.70	11.60	50P	24.50	30.70	25.60
23P	11.00	17.20	12.10	51P	25.00	31.20	26.10
24P	11.50	17.70	12.60				

				JOINT TECH ELECTRONIC IND. CO., LTD. JOY DAY INDUSTRIAL CO., LTD.	
		UNIT	SCALE	SHEET	TITLE:
		mm		1 of 2	0.50mm PITCH FFC/FPC CONNECTOR, 90° SMT TYPE, ZIF, TOP CONTACT STYLE
B5	EN0912080597	2009.12.08	DRAWN BY	APPROVED BY	
B4	EN0911210599	2009.11.21	董正一	董正一	
B3	REVISE	2009.04.30	2002.10.22	2002.10.22	
B2	REVISE	2007.08.02	GENERAL TOLERANCE		
B1	REVISE	2006.05.12	X.X±0.25	ANGLE±	
B0	NEW RELEASE	2005.11.19	X.XX±0.15		
REV.	DESCRIPTION	DATE	X.XXX±0.05		DRAW NO.: F0503WR-S-XPT REV. B5

04~21 Contacts

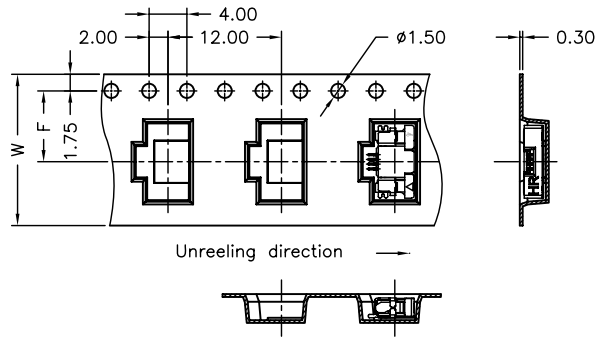

22~51 Contacts

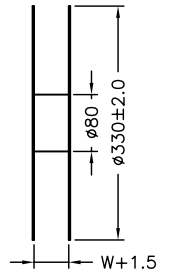
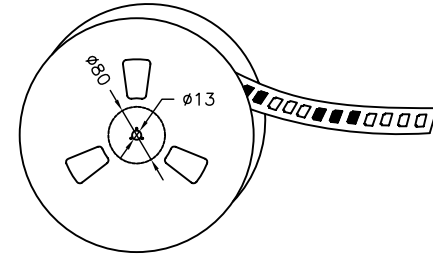
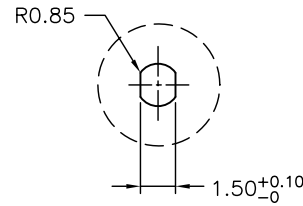
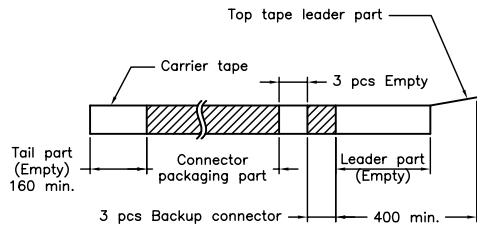
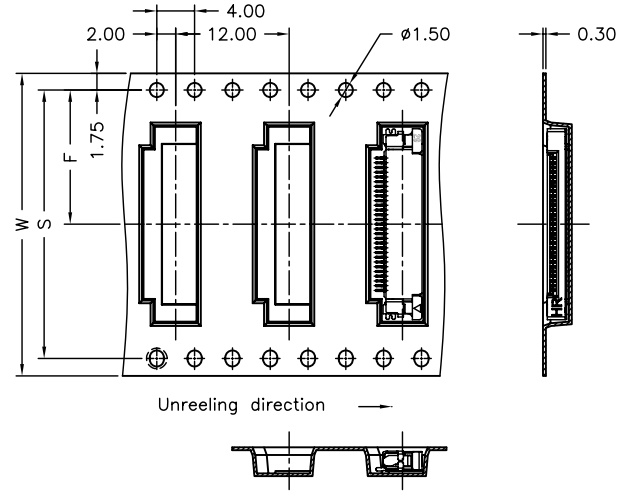

NOTE:
Material: Transparent
Anti-static Polystyrene.

Number of Contacts	W±0.3	F±0.1	S±0.1	Q'ty/Reel	Number of Contacts	W±0.3	F±0.1	S±0.1	Q'ty/Reel
04P	16	7.50	28.40	1,500	25P	32	14.20	28.40	1,500
05P	16	7.50		26P	32	14.20	28.40	1,500	
06P	24	11.50		27P	32	14.20	28.40	1,500	
07P	24	11.50		28P	32	14.20	28.40	1,500	
08P	24	11.50		29P	32	14.20	28.40	1,500	
09P	24	11.50		30P	32	14.20	28.40	1,500	
10P	24	11.50		31P	44	20.20	40.40	1,500	
11P	24	11.50		32P	44	20.20	40.40	1,500	
12P	24	11.50		33P	44	20.20	40.40	1,500	
13P	24	11.50		34P	44	20.20	40.40	1,500	
14P	24	11.50		35P	44	20.20	40.40	1,500	
15P	24	11.50		36P	44	20.20	40.40	1,500	
16P	24	11.50		37P	44	20.20	40.40	1,500	
17P	24	11.50		38P	44	20.20	40.40	1,500	
18P	24	11.50		39P	44	20.20	40.40	1,500	
19P	24	11.50		40P	44	20.20	40.40	1,500	
20P	24	11.50		45P	44	20.20	40.40	1,500	
21P	24	11.50		49P	44	20.20	40.40	1,500	
22P	32	14.20		50P	44	20.20	40.40	1,500	
23P	32	14.20		51P	44	20.20	40.40	1,500	
24P	32	14.20							

				UNIT	SCALE	SHEET	TITLE: 0.50mm PITCH FFC/FPC CONNECTOR, 90° SMT TYPE, ZIF, TOP CONTACT STYLE, TAPING SPEC.
				mm		2 of 2	
DRAWN BY		APPROVED BY		GENERAL TOLERANCE		DRAW NO. : F0503WR-S-XPT	
歐陽小強		謝瑞清					
2007.08.02		2007.08.02		X. X±0.25		ANGLE±	
A2 EN0912080597		2009.12.08		X. XX±0.15		REV. A2	
A1 EN0911210599		2009.11.21		X. XXX±0.05			
A0 NEW RELEASE		2007.08.02					
REV. DESCRIPTION		DATE					