

SPECIFICATIONS

Current Rating: 15A AC,DC
 Voltage Rating: 600V AC,DC
 Temperature Range: $-25^{\circ}\text{C} \sim +85^{\circ}\text{C}$
 Contact Resistance: $3.5\text{m}\Omega$ Max
 Insulation Resistance: $1000\text{M}\Omega$ Min
 Withstanding Voltage: 5000V AC/minute
 Pin Material: Brass/Tin-plated
 Material: Nylon 66,UL94V-0
 Color: Natural(White)

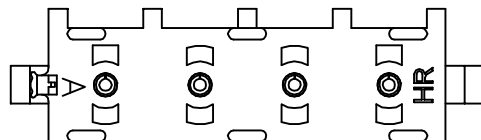
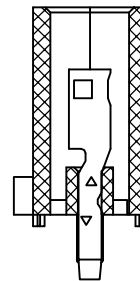
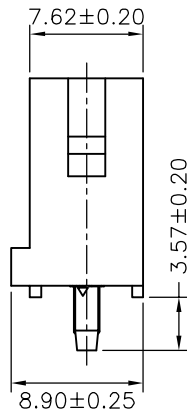
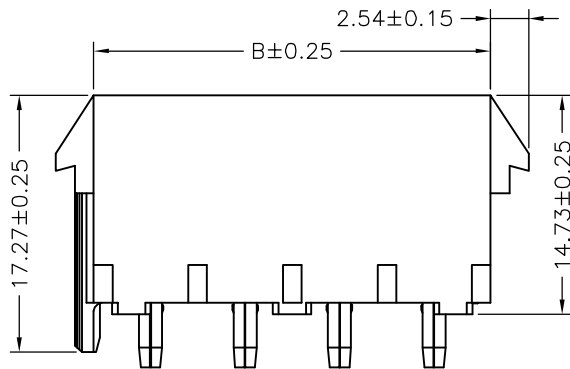

Ordering Information & Dimensions

PART NO.	Dimensions	
	A	B
C6350WV-F-02PFV0	6.35	13.97
C6350WV-F-03PFV0	12.70	20.32
C6350WV-F-04PFV0	19.05	26.67
C6350WV-F-05PFV0	25.40	33.02
C6350WV-F-06PFV0	31.75	39.37
C6350WV-F-08PFV0	44.45	52.07

				JOINT TECH ELECTRONIC IND. CO., LTD. JOY DAY INDUSTRIAL CO., LTD.	
UNIT	SCALE	SHEET	TITLE:		
mm		1 of 1	6.35mm PITCH 180° SINGLE ROW WAFER, POLARIZING PEG, FEMALE TYPE		
DRAWN BY 李勤		APPROVED BY 董正一			
2006.02.25		2006.02.25		C6350WV-F-XPV0	
GENERAL TOLERANCE			REV. A1		
A1	REVISE	2007.09.14	X. X±0.25	ANGLE±	
A0	NEW RELEASE	2006.02.25	X. XX±0.15		
REV.	DESCRIPTION	DATE	X. XXX±0.05		

