

P.C.B. LAYOUT

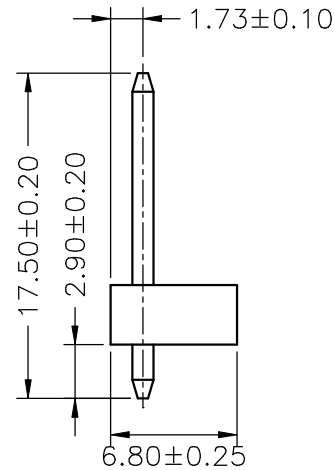
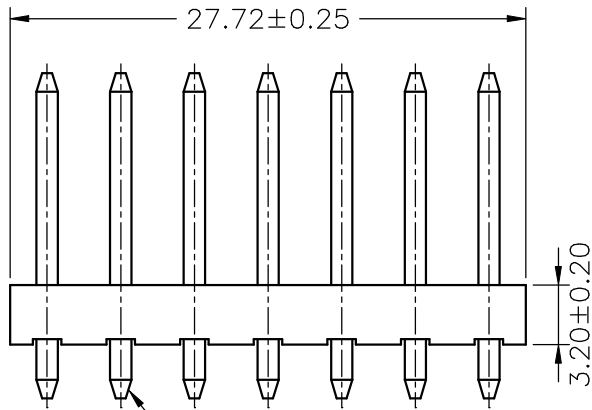
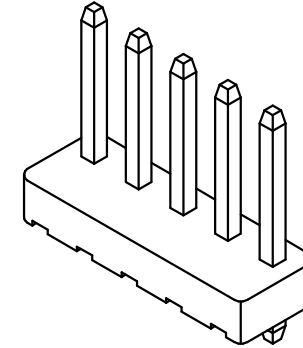

SPECIFICATIONS

Current Rating: 7A AC,DC
 Voltage Rating: 250V AC,DC
 Temperature Range: -25°C ~ +85°C
 Contact Resistance: 10mΩ Max
 Insulation Resistance: 1000MΩ Min
 Withstanding Voltage: 1500V AC/minute
 Pin Material: Brass/Tin-plated
 Material: Nylon 66,UL94V-0
 Color: Natural(White)

				JOINT TECH ELECTRONIC IND. CO., LTD. JOY DAY INDUSTRIAL CO., LTD.	
		UNIT	SCALE	SHEET	TITLE:
		mm		1 of 1	P/N:A3961WVA-07P, 3.96mm PITCH 180° WAFER
		DRAWN BY	APPROVED BY		
		李勤	董正一		
		2006.04.17	2006.04.17		
		GENERAL TOLERANCE			
		X. X±0.25	ANGLE±		
A0	NEW RELEASE	2006.04.17	X. XX±0.15		DRAW NO. :
REV.	DESCRIPTION	DATE	X. XXX±0.05		A3961WVA-07P