

P.C.B LAYOUT

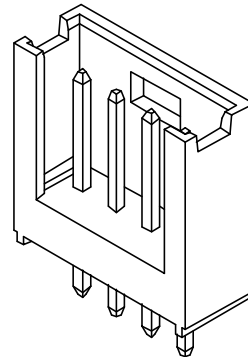
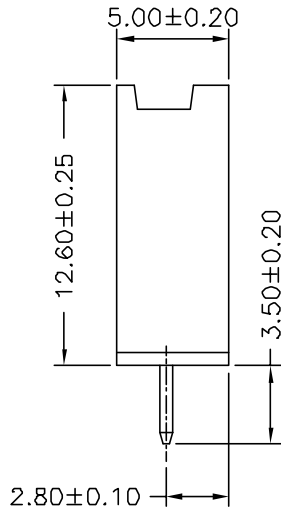

SPECIFICATIONS

Current Rating: 3A AC,DC
 Voltage Rating: 250V AC,DC
 Temperature Range: -25°C ~ +85°C
 Contact Resistance: 20mΩ Max
 Insulation Resistance: 1000MΩ Min
 Withstanding Voltage: 1000V AC/minute
 Pin Material: Brass/Tin-plated
 Material: PBT,UL94V-0
 Color: Natural(Black)

Ordering Information & Dimensions

| PART NO. | Dimensions | |
|-------------|------------|-------|
| | A | B |
| A2543WV-02P | 2.54 | 7.62 |
| A2543WV-04P | 7.62 | 12.70 |
| A2543WV-06P | 12.70 | 17.78 |
| A2543WV-08P | 17.78 | 22.86 |

| | | | | | |
|-----------------|-------------|--------------------|---------------------------|---------|-------|
| | | | | | |
| UNIT | SCALE | SHEET | TITLE: | | |
| mm | | 1 of 1 | 2.54mm PITCH 180 WAFER | | |
| DRAWN BY 董正一 | | APPROVED BY 董正一 | | | |
| | | 2002.04.24 | | | |
| B2 | REVISE | 2008.01.11 | GENERAL TOLERANCE | | |
| B1 | REVISE | 2005.12.20 | X.X ±0.25 | ANGLE ± | |
| B0 | NEW RELEASE | 2005.12.10 | X.XX ±0.15 | | |
| REV. | DESCRIPTION | DATE | X.XXX ±0.05 | | |
| | | | DRAW NO.: | | REV.: |
| | | | A2543WV-XP | | B2 |