

02~05P

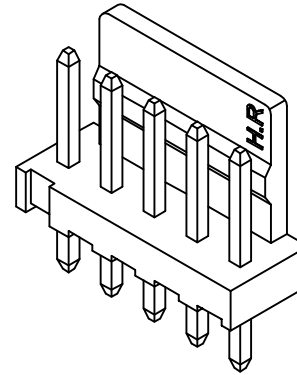

SPECIFICATIONS

Current Rating: 3A AC,DC
 Voltage Rating: 250V AC,DC
 Temperature Range: -25°C ~ +85°C
 Contact Resistance: 10mΩ Max
 Insulation Resistance: 1000MΩ Min
 Withstanding Voltage: 800V AC/minute
 Pin Material: Brass/Tin-plated
 Material: Nylon 66,UL94V-2
 Pantone Color: 7501C

Ordering Information & Dimensions

PART NO.	Dimensions	
	A	B
A2503WV-02P	2.50	5.00
A2503WV-03P	5.00	7.50
A2503WV-04P	7.50	10.00
A2503WV-05P	10.00	12.50
A2503WV-06P	12.50	15.00
A2503WV-07P	15.00	17.50
A2503WV-08P	17.50	20.00
A2503WV-09P	20.00	22.50
A2503WV-10P	22.50	25.00
A2503WV-11P	25.00	27.50
A2503WV-12P	27.50	30.00
A2503WV-13P	30.00	32.50
A2503WV-14P	32.50	35.00
A2503WV-15P	35.00	37.50
A2503WV-16P	37.50	40.00
A2503WV-17P	40.00	42.50
A2503WV-18P	42.50	45.00
A2503WV-19P	45.00	47.50
A2503WV-20P	47.50	50.00

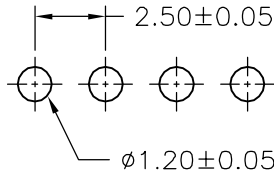
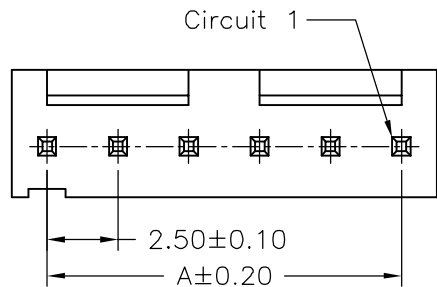

P.C.B LAYOUT

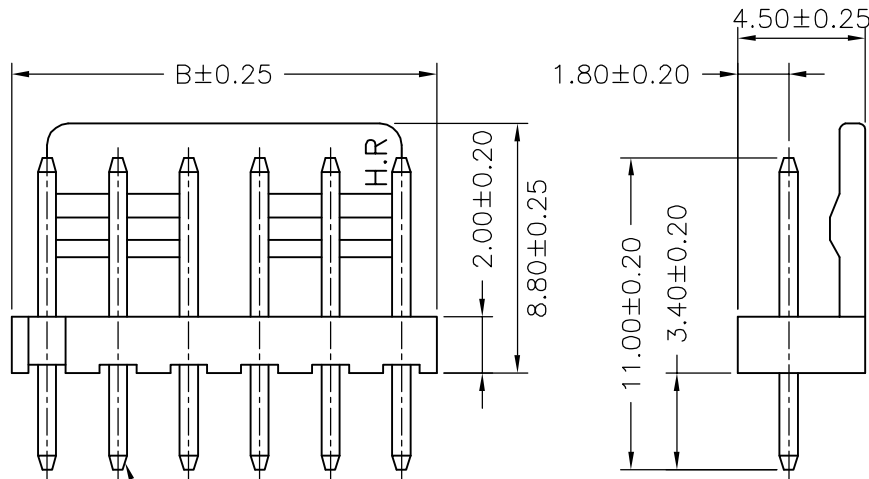

PIN 0.64 SQ

		JOINT TECH ELECTRONIC IND. CO., LTD.		JOY DAY INDUSTRIAL CO., LTD.	
UNIT	SCALE	SHEET	TITLE:		
mm		1 of 1	2.50mm PITCH 180° WAFER		
DRAWN BY		APPROVED BY			
董正一		董正一		DRAW NO. : A2503WV-XP	
2001.02.01		2001.02.01			
GENERAL TOLERANCE					
B1	REVISE	2007.03.18	X. X±0.25	ANGLE±	
B0	NEW RELEASE	2005.12.10	X. XX±0.15	REV. B1	
REV.	DESCRIPTION	DATE	X. XXX±0.05		