

SPECIFICATIONS

Current Rating: 2A AC,DC
 Voltage Rating: 250V AC,DC
 Temperature Range: -25°C ~ +85°C
 Contact Resistance: 30mΩ Max
 Insulation Resistance: 1000MΩ Min
 Withstanding Voltage: 800V AC/minute
 Pin Material: Brass/Tin-plated
 Solder Tabs: Brass/Tin-plated
 Material: Nylon 6T,UL94V-0
 Color: Natural(Beige)

Ordering Information & Dimensions

PART NO.	Dimensions		
	A	B	C
A2211WV-SF-2X02P	2.00	8.50	4.00
A2211WV-SF-2X03P	4.00	10.50	6.00
A2211WV-SF-2X04P	6.00	12.50	8.00
A2211WV-SF-2X05P	8.00	14.50	10.00
A2211WV-SF-2X06P	10.00	16.50	12.00
A2211WV-SF-2X07P	12.00	18.50	14.00
A2211WV-SF-2X08P	14.00	20.50	16.00
A2211WV-SF-2X09P	16.00	22.50	18.00
A2211WV-SF-2X10P	18.00	24.50	20.00
A2211WV-SF-2X11P	20.00	26.50	22.00
A2211WV-SF-2X12P	22.00	28.50	24.00
A2211WV-SF-2X13P	24.00	30.50	26.00
A2211WV-SF-2X14P	26.00	32.50	28.00
A2211WV-SF-2X15P	28.00	34.50	30.00
A2211WV-SF-2X16P	30.00	36.50	32.00
A2211WV-SF-2X20P	38.00	44.50	40.00

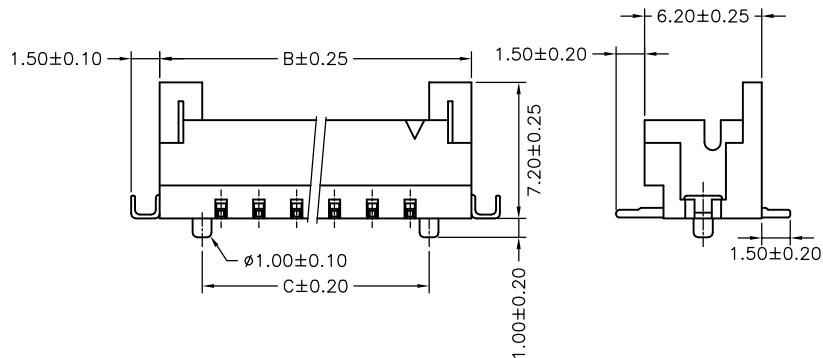
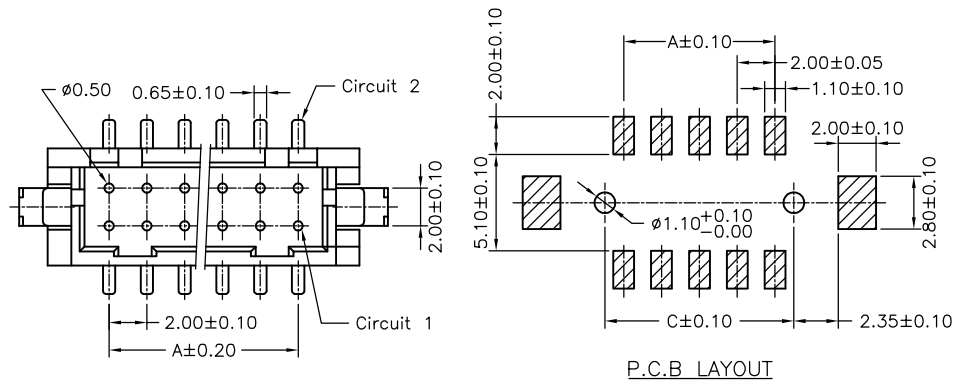

				JOINT TECH ELECTRONIC IND. CO., LTD. JOY DAY INDUSTRIAL CO., LTD.	
		UNIT	SCALE	SHEET	TITLE:
		mm		1 of 1	2.00mm PITCH 180° WAFER-SMT TYPE
		DRAWN BY 董正一 2001.02.01		APPROVED BY 董正一 2001.02.01	
		GENERAL TOLERANCE			
B1	REVISE	2007.02.27	X. X±0.25	ANGLE±	DRAW NO.: A2211WV-SF-2XNP
B0	NEW RELEASE	2005.12.05	X. XX±0.15		
REV.	DESCRIPTION	DATE	X. XXX±0.05		