

SEC:A-A

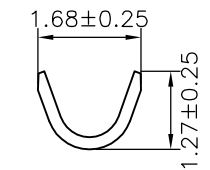

SEC:B-B

Ordering Information & Specifications

Part No.	Wire Range	Insulation O.D.	Material	Finish	Qty/reel
A2001-TPE	AWG#24-#30	1.50mm(max)	Phosphor Bronze	Tin-plated	10,000pcs
A2001-TP	AWG#24-#30	1.50mm(max)	Phosphor Bronze	Tin-plated	10,000pcs
A2001-GPE	AWG#24-#30	1.50mm(max)	Phosphor Bronze	Gold-flash	10,000pcs

Note:E-Stamping before Tin-plated or Gold-flash

			UNIT	SCALE	SHEET
			mm		1 of 1
			DRAWN BY		APPROVED BY
			董正一		董正一
B3	REVISE	2007.09.21	2001.02.01	2001.02.01	
B2	REVISE	2007.04.25	GENERAL TOLERANCE		
B1	REVISE	2006.09.02	X. X±0.25	ANGLE±	
B0	NEW RELEASE	2006.07.21	X. XX±0.15		
REV.	DESCRIPTION	DATE	X. XXX±0.05		
					TITLE:
					2.00mm PITCH CRIMP TERMINAL
					DRAW NO.:
					A2001-XX
					REV. B3