

P.C.B. LAYOUT

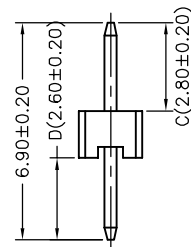
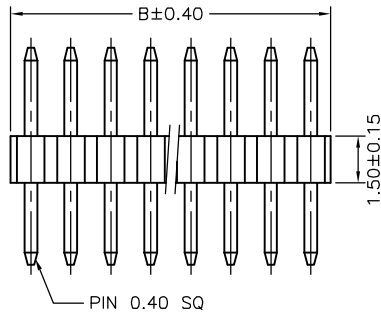

PIN 0.40 SQ

Ordering Information & Dimensions

PART NO.	Dimensions		PART NO.	Dimensions	
	A	B		A	B
A1271WV-03P	2.54	3.81	A1271WV-18P	21.59	22.86
A1271WV-04P	3.81	5.08	A1271WV-19P	22.86	24.13
A1271WV-05P	5.08	6.35	A1271WV-20P	24.13	25.40
A1271WV-06P	6.35	7.62	A1271WV-21P	25.40	26.67
A1271WV-07P	7.62	8.89	A1271WV-22P	26.67	27.94
A1271WV-08P	8.89	10.16	A1271WV-23P	27.94	29.21
A1271WV-09P	10.16	11.43	A1271WV-24P	29.21	30.48
A1271WV-10P	11.43	12.70	A1271WV-25P	30.48	31.75
A1271WV-11P	12.70	13.97	A1271WV-26P	31.75	33.02
A1271WV-12P	13.97	15.24	A1271WV-27P	33.02	34.29
A1271WV-13P	15.24	16.51	A1271WV-28P	34.29	35.56
A1271WV-14P	16.51	17.78	A1271WV-29P	35.56	36.83
A1271WV-15P	17.78	19.05	A1271WV-30P	36.83	38.10
A1271WV-16P	19.05	20.32	A1271WV-31P	38.10	39.37
A1271WV-17P	20.32	21.59	A1271WV-32P	39.37	40.64

SPECIFICATIONS

Current Rating: 1A AC,DC
 Voltage Rating: 250V AC,DC
 Temperature Range: -25°C ~ +85°C
 Contact Resistance: 20mΩ Max.
 Insulation Resistance: 5000MΩ Min.
 Withstanding Voltage: 500V AC/minute
 Pin Material: Brass/Gold-flash
 Material: Nylon 6T,UL94V-0
 Color: Natural(Black)

*Optional Dim. available but
 MOQ requested*

				JOINT TECH ELECTRONIC IND. CO., LTD. JOY DAY INDUSTRIAL CO., LTD.			
UNIT	SCALE	SHEET	TITLE:				
mm		1 of 1	1.27mm PITCH 180° SINGLE ROW PIN HEADER				
DRAWN BY	APPROVED BY					DRAW NO.:	
董正一	董正一					A1271WV-XP	
	2002.05.29	2002.05.29	REV. B1				
GENERAL TOLERANCE							
B1	REVISE	2006.12.03	X.X±0.25	ANGLE±			
B0	NEW RELEASE	2005.11.7	X.XX±0.15				
REV.	DESCRIPTION	DATE	X.XXX±0.05				