

P.C.B. LAYOUT

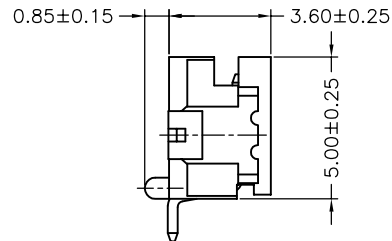

SPECIFICATIONS

Current Rating: 1A AC,DC
 Voltage Rating: 150V AC,DC
 Temperature Range: -25°C ~ +85°C
 Contact Resistance: 30mΩ Max.
 Insulation Resistance: 500MΩ Min.
 Withstanding Voltage: 500V AC/minute
 Pin Material: Brass/Gold-flash
 Solder Tabs: Phosphor Bronze/Gold-flash
 Material: Nylon 6T,UL94V-0
 Color: Natural(Beige)

Ordering Information & Dimensions

| PART NO. | Dimensions | | |
|-------------------|------------|-------|-------|
| | A | B | C |
| A1252WR-SF-02PD01 | 1.25 | 4.15 | 6.25 |
| A1252WR-SF-03PD01 | 2.50 | 5.40 | 7.50 |
| A1252WR-SF-04PD01 | 3.75 | 6.65 | 8.75 |
| A1252WR-SF-05PD01 | 5.00 | 7.90 | 10.00 |
| A1252WR-SF-06PD01 | 6.25 | 9.15 | 11.25 |
| A1252WR-SF-07PD01 | 7.50 | 10.40 | 12.50 |
| A1252WR-SF-08PD01 | 8.75 | 11.65 | 13.75 |
| A1252WR-SF-09PD01 | 10.00 | 12.90 | 15.00 |
| A1252WR-SF-10PD01 | 11.25 | 14.15 | 16.25 |
| A1252WR-SF-11PD01 | 12.50 | 15.40 | 17.50 |
| A1252WR-SF-12PD01 | 13.75 | 16.65 | 18.75 |
| A1252WR-SF-13PD01 | 15.00 | 17.90 | 20.00 |
| A1252WR-SF-14PD01 | 16.25 | 19.15 | 21.25 |
| A1252WR-SF-15PD01 | 17.50 | 20.40 | 22.50 |

| | | | |
|-------------------|-------------|------------|--|
| | | | |
| UNIT | SCALE | SHEET | TITLE: |
| mm | | 1 of 2 | 1.25mm PITCH 90° SINGLE ROW WAFER- SMT TYPE |
| DRAWN BY | APPROVED BY | | |
| 李勤 | 董正一 | | |
| 2006.05.31 | 2006.05.31 | | |
| GENERAL TOLERANCE | | | DRAW NO. : A1252WR-SF-XPD01 |
| X. X±0.25 | ANGLE± | | |
| AO | NEW RELEASE | 2006.05.31 | REV. A0 |
| REV. | DESCRIPTION | DATE | |

02~08 Contacts

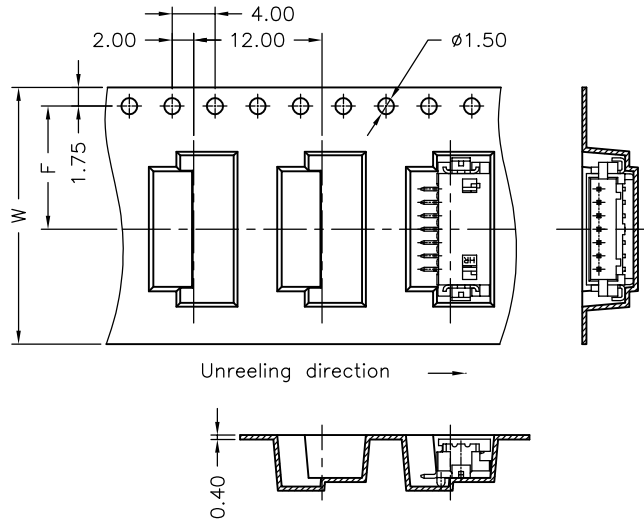

09~15 Contacts

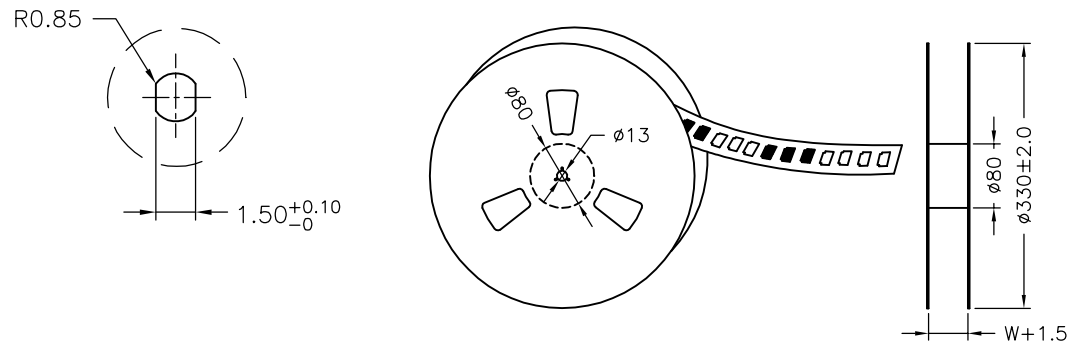
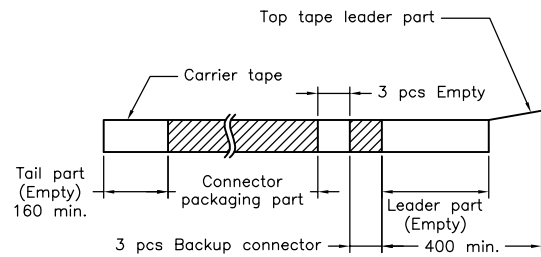
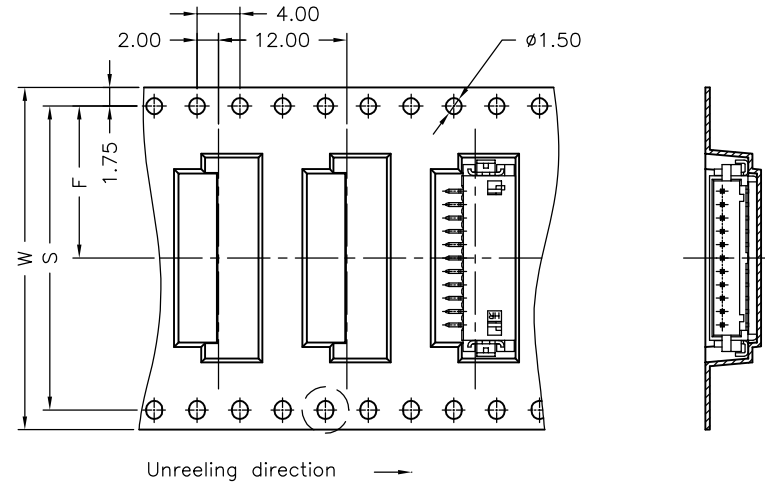

| Number of Contacts | W±0.3 | F±0.1 | S±0.1 | Q'ty/Reel |
|--------------------|-------|-------|-------|-----------|
| 02P | 16 | 7.50 | / | 1,000 |
| 03P | 16 | 7.50 | | 1,000 |
| 04P | 24 | 11.50 | | 1,000 |
| 05P | 24 | 11.50 | | 1,000 |
| 06P | 24 | 11.50 | | 1,000 |
| 07P | 24 | 11.50 | | 1,000 |
| 08P | 24 | 11.50 | | 1,000 |
| 09P | 32 | 14.20 | | 28.40 |
| 10P | 32 | 14.20 | 28.40 | 1,000 |
| 11P | 32 | 14.20 | 28.40 | 1,000 |
| 12P | 32 | 14.20 | 28.40 | 1,000 |
| 13P | 32 | 14.20 | 28.40 | 1,000 |
| 14P | 44 | 20.20 | 40.40 | 1,000 |
| 15P | 44 | 20.20 | 40.40 | 1,000 |

| | | | | | | | |
|------------|--|-------------|--|---|-------|--------|--------|
| | | | | UNIT | SCALE | SHEET | TITLE: |
| | | | | mm | | 2 of 2 | |
| DRAWN BY | | APPROVED BY | | GENERAL TOLERANCE | | | |
| 李勤 | | 董正一 | | | | | |
| 2006.05.31 | | 2006.05.31 | | REV. DESCRIPTION DATE X.X±0.25 ANGLE± X.XX±0.15 X.XXX±0.05 | | | |
| A1 | | REVISE | | | | | |
| A0 | | NEW RELEASE | | 2006.05.31 | | | |